



**1**

Insert MEMo Chip®.  
Turn analyzer on.

Inserte MEMo Chip.  
Encienda el instrumento.

Insérez MEMo Chip.  
Allumez l'appareil.

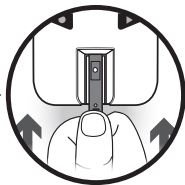

**2**

Insert the test strip.

Inserte tira.

Allumez l'appareil.



**3**

Stick finger.

Hurga su dedo.

Piquez l'extrémité

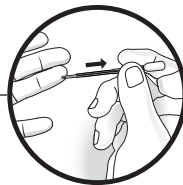

**4**

Collect sample.

Toma muestra.

Prélever l'échantillon.

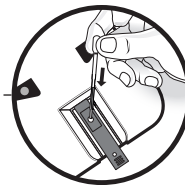

**5**

Apply blood to test strip.

Aplique muestra.

Appliquer le sang à la bande.

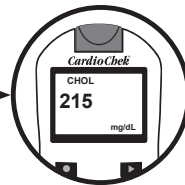

**6**

Read results.

Lea los resultados.

Lire les résultats.



**1**

MEMo Chip einstecken.  
Analysator einschalten.

Inserire MEMo Chip.  
Accendere l'analizzatore.

Invoeren MEMo Chip.  
Analyzer inschakelen.

Introduza o MEMo Chip.  
Ligue o Analisador.

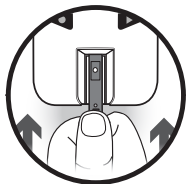

**2**

Teststreifen einstecken.

Inserire la striscia per il test.

Invoeren test strip.

Introduza a tira de teste.



**3**

Finger einstecken.

Pungere il dito.

Vinger prikken.

Espete o dedo.

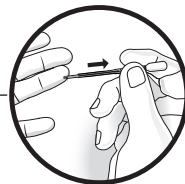

**4**

Probe sammeln.

Raccogliere il campione.

Monster afnemen.

Recolha a amostra.

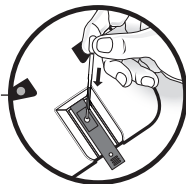

**5**

Blut an Streifen anbringen.

Applicare il sangue sulla striscia.

Bloed op strip aanbrengen.

Aplique o sangue na tira.

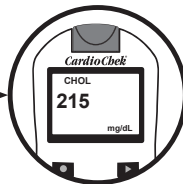

**6**

Ergebnisse ablesen.

Leggere i risultati.

Resultaten aflezen.

Leia os resultados.

DE

IT

NL

PT